

ADUTORAS FP-12 E FP-12-02

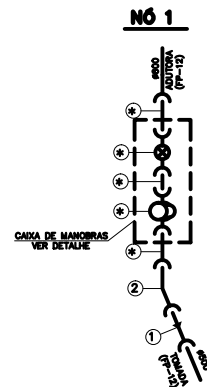

PEÇAS	QUANT.
1 RJGS F" F" (600x500)	01
2 C22PB PRFV #600	01

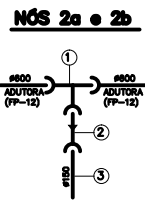

PEÇAS	QUANT.
1 TBPB PRFV (600x300)	01
2 RPBGS F" F" (300x150)	01
3 TUBO PVC (L=3,00m)	01

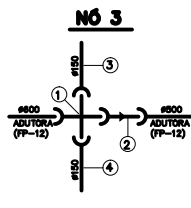

PEÇAS	QUANT.
1 XR PRFV PBPP (600x150)	01
2 RBPJE PRFV (600x500)	01
3 TUBO PVC PB (L=3,00m)	01
4 TUBO PVC PB (L=6,00m)	01

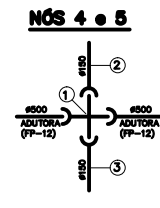

PEÇAS	QUANT.
1 XR PRFV PBPP (500x150)	01
2 TUBO PVC PB (L=3,00m)	01
3 TUBO PVC PB (L=6,00m)	01

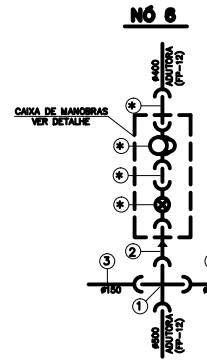

PEÇAS	QUANT.
1 XR PRFV PBPP (500x150)	01
2 RBPJE PRFV (500x400)	01
3 TUBO PVC PB (L=3,00m)	01
4 TUBO PVC PB (L=6,00m)	01

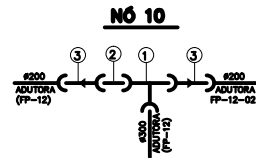

PEÇAS	QUANT.
1 TBPB PRFV (300x300)	01
2 TOCO C/ PONTAS TUBO PVC #300 (L=0,50m)	01
3 RBPJE PRFV (300x200)	02

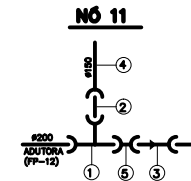

PEÇAS	QUANT.
1 TBPB PRFV (200x150)	01
2 TOCO C/ PONTAS TUBO PVC #150 (L=0,50m)	01
3 RJGS F" F" (200x150)	01
4 TUBO PVC C/ PONTAS (L=3,00m)	02
5 LUVA DE CORRER #200	01

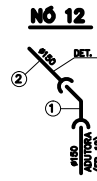

PEÇAS	QUANT.
1 C45PB PRFV #150	01
2 TUBO PVC (L=3,00m)	01

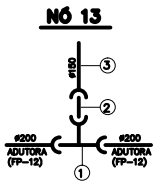

PEÇAS	QUANT.
1 TBPB PRFV (200x150)	01
2 TOCO C/ PONTAS TUBO PVC #150 (L=0,50m)	01
3 TUBO PVC PB (L=3,00m)	01

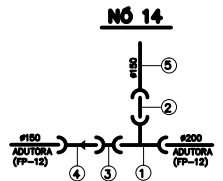

PEÇAS	QUANT.
1 TBPB PRFV (200x150)	01
2 TOCO C/ PONTAS TUBO PVC #150 (L=0,50m)	01
3 LUVA DE CORRER PRFV #200	01
4 RPBGS F" F" (200x150)	01
5 TUBO PVC C/ PONTAS (L=3,00m)	01

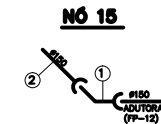

PEÇAS	QUANT.
1 C45PB PRFV #150	01
2 TUBO PVC PB (L=3,00m)	01

ADUTORA FP-14

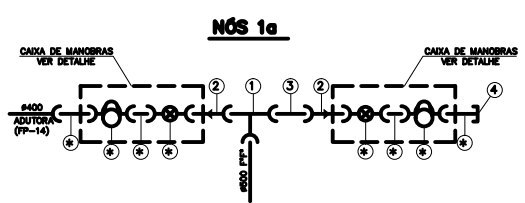

PEÇAS	QUANT.
1 TBPB PRFV (500x500)	01
2 RBPJE PRFV (500x400)	02
3 TOCO C/ PONTAS TUBO PRFV #500 (L=0,50m)	01
4 CAP F" F" #400	01

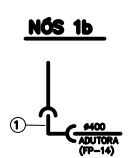

PEÇAS	QUANT.
1 C90PB PRFV #400	01

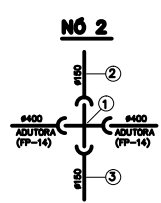

PEÇAS	QUANT.
1 XR PRFV PBPP (400x150)	01
2 TUBO PVC PB (L=3,00m)	01
3 TUBO PVC PB (L=6,00m)	01

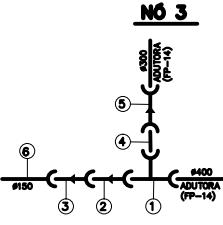

PEÇAS	QUANT.
1 TBPB BPB PRFV (400x400)	01
2 RBPJS PRFV (400x250)	01
3 RBPJE PRFV (250x150)	01
4 TOCO C/ PONTAS TUBO PRFV #400 (L=0,50m)	01
5 RJGS F" F" C/ BOLSAS (400x300)	01
6 TUBO PVC PB (L=3,00m)	01

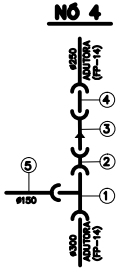

PEÇAS	QUANT.
1 TBPB PRFV (300x150)	01
2 LUVA DE CORRER PVC #300	01
3 RPBGS F" F" (300x250)	01
4 TOCO C/ PONTAS TUBO PVC #250 (L=0,50m)	01
5 TUBO PVC PB (L=3,00m)	01

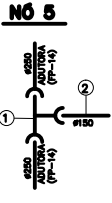

PEÇAS	QUANT.
1 TBPB PRFV (250x150)	01
2 TUBO PVC (L=6,00m)	01

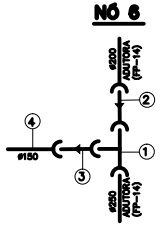

PEÇAS	QUANT.
1 TBPB PRFV (250x250)	01
2 RBPJE PRFV (250x200)	01
3 RBPJE PRFV (250x150)	01
4 TUBO PVC PB (L=3,00m)	01

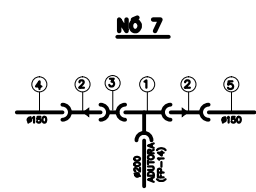

PEÇAS	QUANT.
1 TBPB PRFV (200x200)	01
2 RBPJE F" F" (200x150)	02
3 LUVA DE CORRER PRFV #200	01
4 TUBO PVC C/ PONTAS (L=3,00m)	01
5 TUBO PVC C/ PONTAS (L=6,00m)	01

NOTAS:

1 - PARA AS ADUTORAS COM DIÂMETRO NOMINAL ATÉ 300mm, SERÃO UTILIZADA TUBULAÇÕES EM PVC. PARA AS DEMAIS ADUTORAS, SERÃO UTILIZADA TUBULAÇÕES EM PRFV.

DESENHOS DE REFERÊNCIA:

GER-HID-02-02
ADU-HID-05-02
ADU-HID-06-02

REVISÃO	DESCRIÇÃO	DESENHO	VERIFICAÇÃO	APPROVAÇÃO	DATA
01	ELABORAÇÃO DO PROJETO				10/2014



www.magnaeng.com.br e-mail: magna@magnaeng.com.br

CLIENTE



Companhia de Desenvolvimento dos Vales do São Francisco e do Parnaíba

PROJETO BAIXO DE IRECÉ - ETAPA 1-A ATUALIZAÇÃO E ADEQUAÇÃO DO PROJETO EXECUTIVO					
FASE 2 (Lotes 16ha) SISTEMA DE DISTRIBUIÇÃO		ADUTORAS FP-12, FP-12-02 E FP-14 - DETALHES DOS NÓS			
1552-D-ADU-HID-12-05	S/ESCALA	10/2014	ADU-HID-12		